

Features:

- High efficiency, high reliability
- Universal AC input / Full range
- 100% full load burn-in test
- Protections: Short circuit/ Over load/ Over voltage
- Forced air cooling by built in DC fan
- Built-in cooling Fan ON-OFF control
- 1 year warranty
- Dimensions: 215*115*50mm(L*W*H)



MODEL		SKS-250 -5	SKS-250 -7.5	SKS-250 -12	SKS-250 -13.5	SKS-250 -15	SKS-250 -24	SKS-250 -27	SKS-250 -48	
OUTPUT	DC VOLTAGE	5V	7.5V	12V	13.5V	15V	24V	27V	48V	
	VOLTAGE TOLERANCE	±2%	±2%	±1%	±1%	±1%	±1%	±1%	±1%	
	RATED CURRENT	40A	30A	20A	18.5A	16.6A	10A	9.3A	5.2A	
	CURRENT RANG	0-40A	0-30A	0-20A	0-18.5A	0-16.6A	0-10A	0-9.3A	0-5.2A	
	RATED POWER	200W	225W	240W	250W	249W	240W	251W	250W	
	RIPPLE & NOISE	120mVp-p	120mVp-p	150mVp-p	150mVp-p	150mVp-p	150mVp-p	200mVp-p	240mVp-p	
	DC,ADJUSTMENT RANGE	-10%, +12%	±20%	-16%, +10%	-12%, +11%	-10%, +20%	-16%, +10%	-4%, +18%	-15%, +17%	
	SETUP,RISE,HOLD TIME	200ms,50ms,20ms								
INPUT	VOLTAGE RANGE	90~132 VAC/180~264VAC 47~63 Hz; selected by switch 254~370VDC								
	AC CURRENT	5.5A/115 V 3.5A/ 230 V								
	EFFICIENCY	74%	76%	78%	79%	78%	82%	82%	83%	
	INRUSH CURRENT	Cold start 25A/115V 50A/230V								
	LEAKAGE CURRENT	<3.5 mA/240VAC								
PROTECTION	OVER LOAD	105%~135% Protection type: hiccup mode, recovers automatically after fault condition is removed.								
	OVER VOLTAGE	115%~135% Protection type: hiccup mode, recovers automatically after fault condition is removed.								
	COOLING TYPE	RTH3≥45℃ FAN ON ≤40℃ FAN OFF, ≥85℃ output shutdown								
ENVIRONMENT	WORKING,TEMP., HUMIDITY	-10℃~+50℃; 20%~90 %RH								
	STORAGE,TEMP.,HUMIDITY	-20℃~+85℃; 10%~95 %RH								
	VIBRATION	10~500Hz, 2G 10min./1cycle, period for 60min, each along X, Y, Z axes								
SAFETY	WITHSTAND VOLTAGE	I/P-O/P: 1.5KVAC I/P-FG: 1.5KVAC O/P-FG: 0.5KVAC								
	ISOLATION RESISTANCE	I/P-O/P, I/P-FG, O/P-FG: 100M Ohms/500VDC								
STANDARD	SAFETY STANDARD	Design refer to UL1950								
	EMC STANDARD	Design refer to EN55022, EN55024, EN61000								
OTHERS	WEIGHT	1.15Kg								
	PACKING	12pcs/13.8Kg/0.98CUFT								
NOTE	<ol style="list-style-type: none"> All parameters NOT specially mentioned are measured at 230VAC input, rated load and 25℃ of ambient temperature. Ripple & noise are measured at 20MHz of bandwidth by using a 12" twisted pair-wire terminated with a 0.1 μ & 47 μ parallel capacitor. Tolerance: includes set up tolerance, line regulation and load regulation. 									

Outline and Dimension:

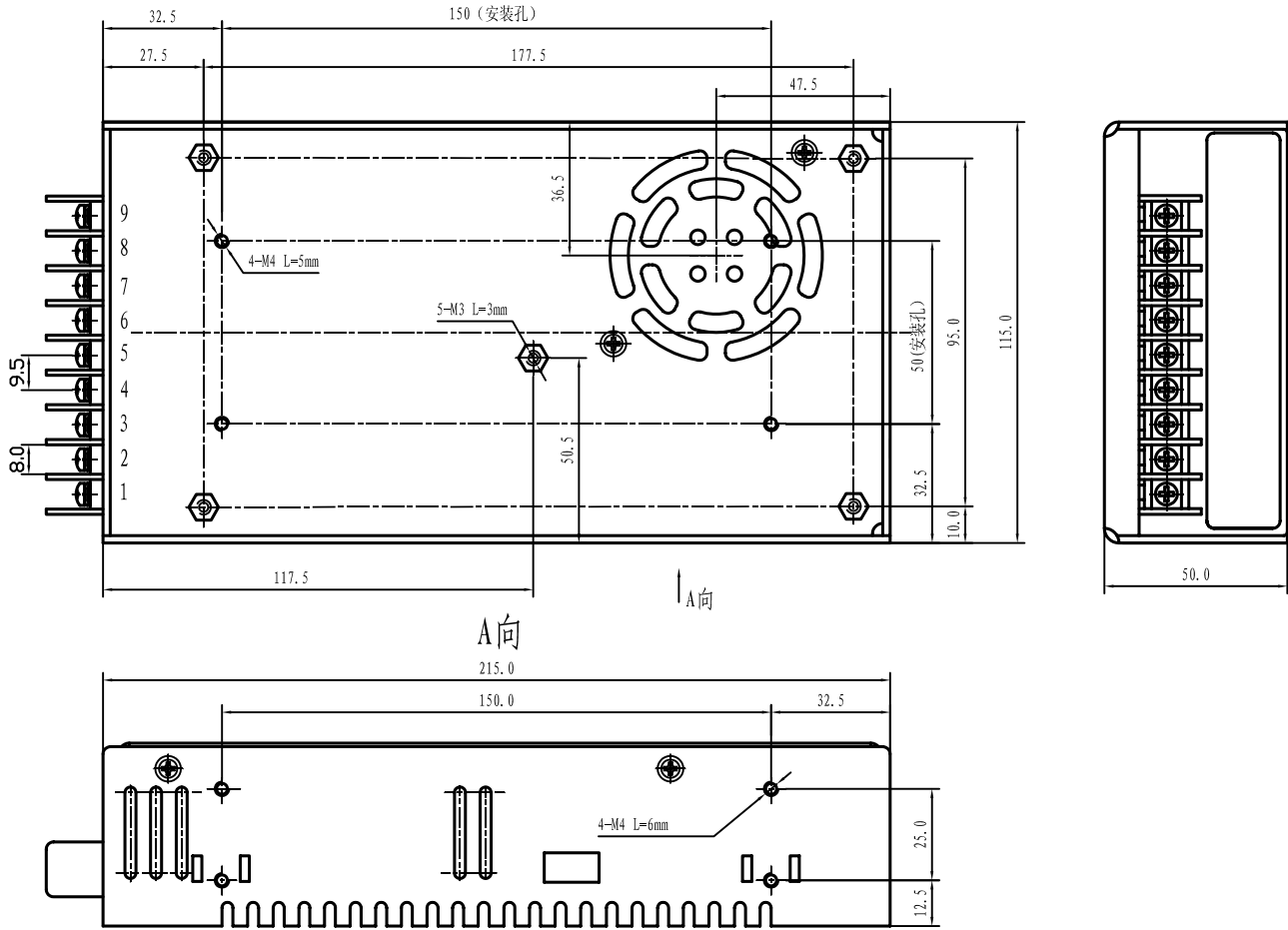

Terminal Pin No. Assignment:

Pin No.	Assignment	Pin No.	Assignment
1	AC/L	4~6	DC OUTPUT -V
2	AC/N	7~9	DC OUTPUT +V
3	FG		

Derating Curve

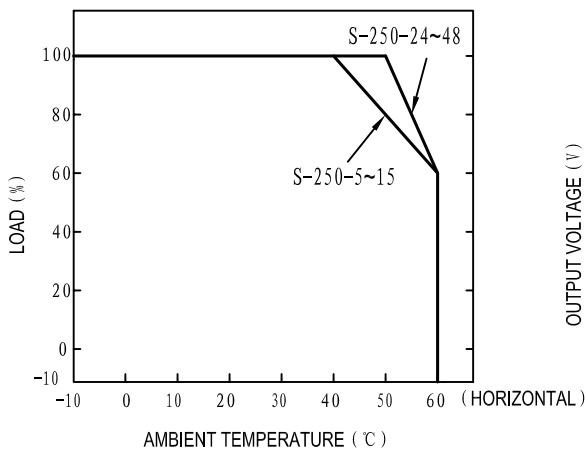

Static Characteristics (24V)

